



# Warranty Program

Congratulations on your decision to install the world's finest high performance, high efficiency shower. It is likely to be the last shower fixture you will ever have to buy! ETL® is pleased to provide you with the ultimate product warranty.

## **NEED HELP? CALL CUSTOMER SERVICE!**

If you are missing parts or have questions about the product you purchased, please do not return to this item to the store where it was purchased. Please call 1-866-440-9257 or 775-398-7680 for customer service assistance, business hours are Monday through Friday 7:30 AM to 4:30 PM (PST).

## **LIMITED LIFETIME PERFORMANCE WARRANTY**

Oxygenics showerheads are lifetime warranted never to clog or fail to operate properly. In the event of clogging or failure ETL will, at its election, repair, replace or make appropriate adjustment where ETL inspection discloses any defects occurring in normal usage. Defects or damage caused by use of other than genuine ETL parts are not covered by this warranty.

## **CONDITIONS**

This warranty does not cover loss or damage of any kind resulting directly or indirectly from alteration, misuse or abuse of the product, or from its installation or removal (including scratching). ETL's liability under this warranty shall not in any case exceed the contract price for the product. ETL reserves the right to make changes and improvements in its products without incurring any obligation to similarly alter products previously purchased. WARRANTY SHALL NOT EXTEND TO INCIDENTAL OR CONSEQUENTIAL DAMAGES INCURRED AS A CONSEQUENCE TO ANY DEFECTS COVERED BY THIS WARRANTY, nor shall it apply to normal wear and tear, or when misuse, negligence, or accident are evident. This warranty is in lieu of all other warranties, express or implied. No one is authorized to assume any other liability for ETL in connection with this product. This warranty gives you specific rights. You may have other rights under state law. Warranty is only valid within the U.S.

## **ONLINE AUCTION PURCHASES**

Products sold through online auctions are not eligible for rebates or other special offers from ETL. Online auction confirmations are not accepted for warranty verification. To obtain warranty service, an original or copy of the sales receipt from the original retailer is required. ETL will not replace missing components from any package purchased through an online auction.

See Reverse Side for Installation Instructions

ETL  
976 United Circle  
Sparks, NV 89431  
P: 1-866-440-9257 or 775-398-7680  
E: support@oxygenics.com

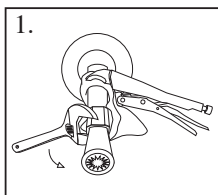

1. Remove existing showerhead.

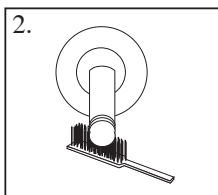

2. Using a wire brush or steel wool, thoroughly clean threaded area of existing shower arm.

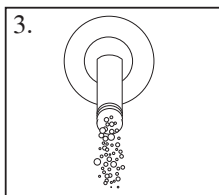

3. Flush out shower pipe for 5 to 10 seconds.

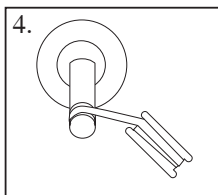

4. Wrap Teflon tape clockwise 3 turns around threaded end of shower arm. (Proceed to step 5b. if installing provided adjustable arm.)

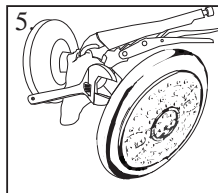

5. In a clockwise direction, screw showerhead onto the taped portion of shower arm. Place cloth inside the crescent wrench grip area and tighten slightly. Your showerhead installation is now complete!

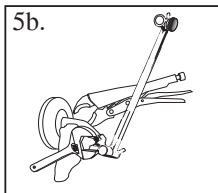

5b. In a clockwise direction, screw adjustable arm onto the taped portion of existing shower arm. Place cloth inside the crescent wrench grip area and tighten slightly.

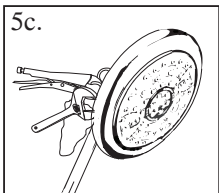

5c. Repeat step 4. to the end of the adjustable arm then in a clockwise direction, screw showerhead onto the end of the arm. Place cloth inside the crescent wrench grip area and tighten slightly.

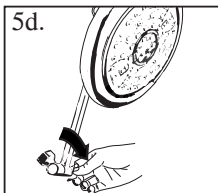

5d. Adjust arm to desired height, then tighten adjustable arm fasteners. Your showerhead installation is now complete!

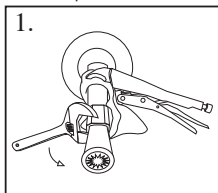

1. Retire la regadera existente.

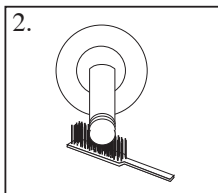

2. Limpie profundamente el área roscada del brazo de ducha existente con un cepillo de metal o lana de acero.

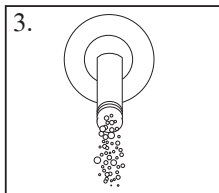

3. Haga correr agua por la tubería de la ducha durante 5 a 10 segundos.

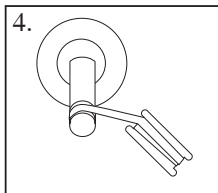

4. Coloque 3 vueltas hacia la derecha de cinta de teflón alrededor del extremo roscado del brazo de ducha. (Proceda al paso 5b. en caso que probee una manecilla ajustable)

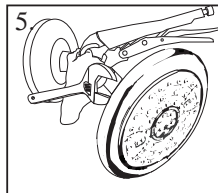

5. Enrosque hacia la derecha la regadera en la parte con cinta del brazo de la ducha. Coloque un paño dentro del área de sujeción de la llave sueca y apriete suavemente. La instalación de tu regadera ahora esta completa!

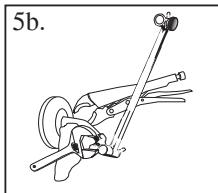

5b. Enrosque hacia la derecha la manecilla ajustable en la parte con cinta del brazo de la ducha. Colo que un paño dentro del área y apriete suavemente.

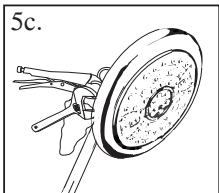

5c. Repita el paso numero 4. al final de la manecilla ajustable despues en dirección a la derecha enrosque la regadera al final del brazo de la ducha. Coloque un paño dentro del área de sujecion de la llave sueca y apriete suavemente.

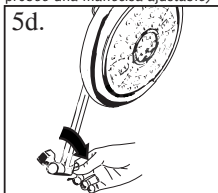

5d. Ajuste la manecilla a la altura preferible, despues apriete cierre. La instalación de tu regadera ahora esta completa!